

# Instructions for Emergency Lighting Fixture

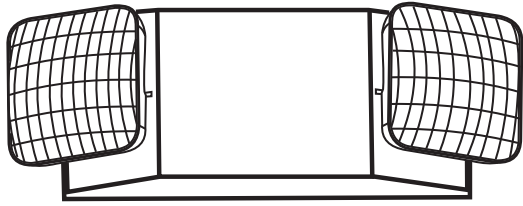

## IMPORTANT

The battery in this unit may not be fully charged. After electricity is connected to unit, let battery charge up for at least 24 hours. Then the normal operation of this unit should take effect. To check press the "TEST" button and the lights on the unit should turn ON.

## IMPORTANT SAFEGUARDS

When using electrical equipment, basic safety precautions should always be followed including the following:

## READ AND FOLLOW ALL SAFETY INSTRUCTIONS

1. Do not use outdoors.
2. Equipment should be mounted in locations and heights where it will not be subject to tampering by unauthorized personnel.
3. Do not mount near gas or electric heaters.
4. The use of accessory equipment not recommended by the manufacturer may cause an unsafe condition.
5. Do not use this equipment for anything other than its intended use.
6. Servicing of this equipment should be performed by qualified personnel.
7. Disconnect AC power before servicing.

## SAVE THESE INSTRUCTIONS!

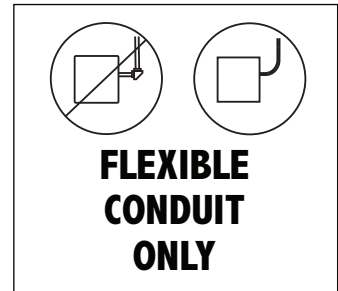

## INSTALLATION (J-BOX MOUNTING)

1. Feed fixture leads and extra lamp wires through the Base Plate and connect fixture leads to AC power supply (Fig. A). Extra lamp wires are to be used for remote lamp heads.
2. Connect wires through J-BOX. Mount Base Plate on J-BOX and secure with screws.
3. Connect battery only after continuous AC power is being supplied to the unit (Fig. B).
4. Align snaps and push housing directly onto the Base Plate (Fig. C). Apply continuous AC power for 2 hours and then press "TEST" button to check light.

## INSTALLATION (CONDUIT)

1. Secure Base Plate to wall surface. Route wires through hole in the conduit flange and make conduit connection. Use flexible conduit only.
2. Connect battery only after continuous AC power is being supplied to the unit (Fig. B).
3. Align snaps and push housing directly onto the Base Plate (Fig. C). Apply continuous AC power for 2 hours and then press "TEST" button to check light.

**NOTE:** The blue sleeve on one of the battery connectors (one coming from the battery) needs to be pulled back for easy connection of the connectors.

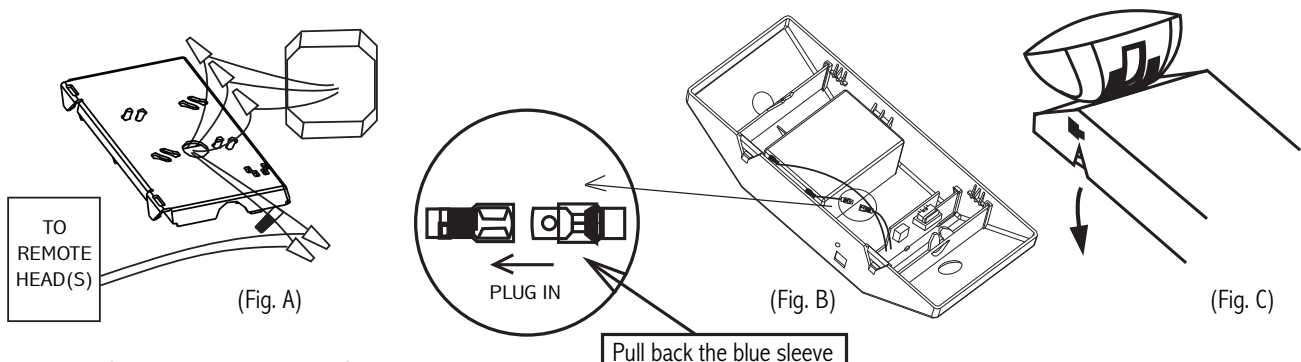

**WARNING:** Unused wires must be capped using enclosed wire nuts.

# WARNING: Unused wires must be capped using enclosed wire nuts.

## OPERATION

1. During an electrical power failure, the lamps on the unit will automatically come ON for a minimum of 90 minutes.
2. To test this unit, let it charge correctly with AC power supply for a minimum of 2 hours after its first installation and then depress the "TEST" switch. The emergency lamps will illuminate. When the switch is released, the lamps will turn OFF.

## WIRING DIAGRAM

